



Jim and Mindy Wiese Missionaries to Samoa

P.O. Box 1166 Apia Samoa WS 1139

Trust in the LORD with all thine heart; and lean not unto thine own understanding. In all thy ways acknowledge him, and he shall direct thy paths. Proverbs 3:5,6

March 2, 2023

Greetings,

In May of 2020 God gave us a vision for Samoa that is bigger than we could have imagined. We wrote it down we presented it to leadership and have waited. In March of 2021 we registered the vision as a charitable trust and have a Samoan board of trustees in place. March of 2022 we received blue print of that vision and have waited.

The Samoa Outreach and Learning Center project has been approved!

Name of Project: Samoa Outreach and Learning Center

Project #: 102-9642

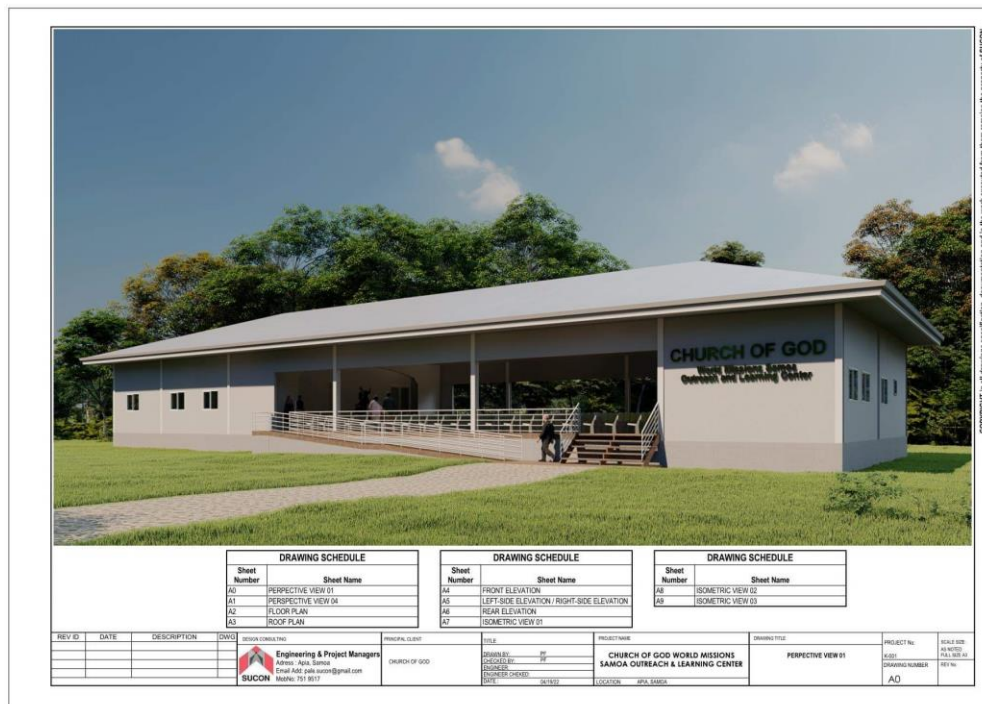



Jim and Mindy Wiese Missionaries to Samoa

P.O. Box 1166 Apia Samoa WS 1139



COPYRIGHT in all drawings, specifications, documentation and in the work executed herein remain the property of SUCON

REV. ID	DATE	DESCRIPTION	DNWG	DESIGN/CONSULTING	PRINCIPAL CLIENT	TITLE	PROJECT NAME	DRAWING TITLE	PROJECT No.	SCALE
				Engineering & Project Managers Apia - Apia Samoa Email: info.succon@gmail.com Mobile: 753 8817	CHURCH OF GOD	DRAWN BY: JP CHECKED BY: JP COUNTER CHECKED: JP DATE: 04/2015	CHURCH OF GOD WORLD MISSIONS SAMOA OUTREACH & LEARNING CENTER	PERSPECTIVE VIEW 04	SUCON DRAWING NUMBER A1	SCALE 1:50 FULL SET SET No.

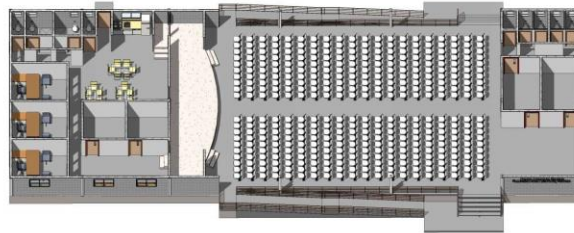

ISOMETRIC VIEW 03
SCALE

COPYRIGHT in all drawings, specifications, documentation and in the work executed herein remain the property of SUCON

REV. ID	DATE	DESCRIPTION	DNWG	DESIGN/CONSULTING	PRINCIPAL CLIENT	TITLE	PROJECT NAME	DRAWING TITLE	PROJECT No.	SCALE
				Engineering & Project Managers Apia - Apia Samoa Email: info.succon@gmail.com Mobile: 753 8817	CHURCH OF GOD	DRAWN BY: JP CHECKED BY: JP COUNTER CHECKED: JP DATE: 04/2015	CHURCH OF GOD WORLD MISSIONS SAMOA OUTREACH & LEARNING CENTER	ISOMETRIC VIEW 03	SUCON DRAWING NUMBER A2	SCALE 1:50 FULL SET SET No.



Jim and Mindy Wiese Missionaries to Samoa
P.O. Box 1166 Apia Samoa WS 1139

THE VISION FOR SAMOA
CHURCH OF GOD WORLD MISSIONS OUTREACH CENTER

Development of a Campus that allows for outreach to the nations

A place of worship and learning

Develop Partnerships with the community to meet the needs of the people of Samoa

Facilitate Discipleship Training

Provide distribution facilities to provide benevolence to the people of Samoa

Provide a clinical facility for medical mission's teams to utilize

Expand the vision as God allows to bless Samoa

Provide Housing for Missionaries and Teams that come to minister in Samoa

Email: livingongrace2015@gmail.com

Prayer Request and Praises !

- 1. Pray for the Harvest of Souls!**
- 2. Praise! We are utilizing goods received !**
3. THE SOLC has been approved ! Pray for funding and favor with government for land.
4. Praise Great Harvest COG found a house for now to rent for church!
5. Samaritan's Purse Operation Christmas Child Training completed! Now Outreach!
6. Pray for Ministry and or Medical teams to come.
7. Mindy's registration as RN to volunteer for Campus of Hope Clinic will be implemented great things are happening.
8. Thank you to all that support us in this journey!

New Online Giving link <https://www.cogwm.org/shop/wiese/>

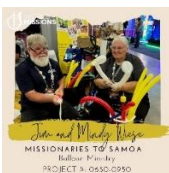

In Christ,

Jim and Mindy Wiese Missionaries to Samoa

Project #0650-0950 – Jim and Mindy Monthly and Ministry Expenses

Project #: 102-9642 – Special Project the Samoa Outreach and Learning Center



Jim and Mindy Wiese Missionaries to Samoa
P.O. Box 1166 Apia Samoa WS 1139

Thank you Awakening Church of God for Action Bibles! Thank you to all of our supporters!
Thank you Life Church Potosi Missouri - The puppets have been a success at the Campus of Hope



We have started back at the school teaching English using the Action Bible. 8th Grade two classes.



Campus of Hope Puppets! These are Josephs brothers and have been forgiven.